

# CURVATURE RADIUS AND STATION MEASURES COMPARISON

**ML100**

**ML75**

**ML50**



up to Ø114mm  
abrasive belts 50mm width

up to Ø76,2mm  
abrasive belts 25mm width

up to Ø51mm  
abrasive belts 25mm width

\_\_ Straight tubes and large radius

\_\_ Curved tubes up to Ø76mm with tight radius

\_\_ Small diameter tubes with very tight radius

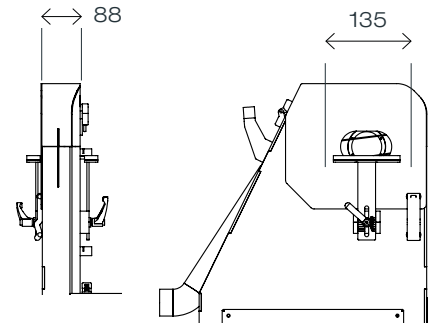
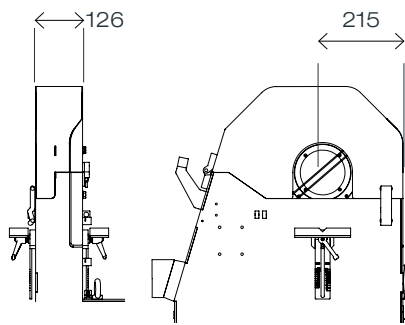
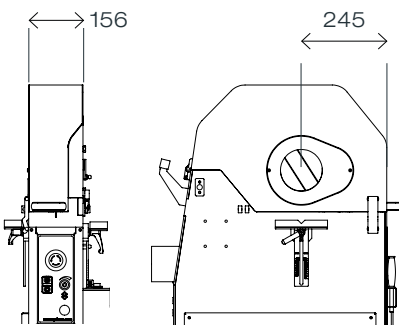

raio min. (mm)

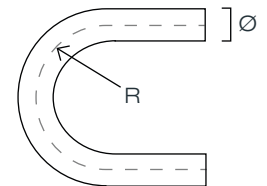
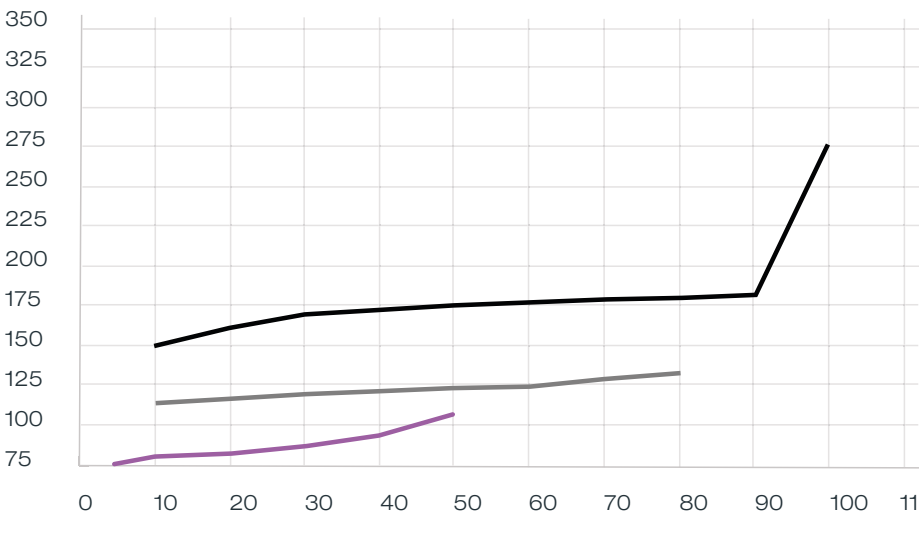

- **ML50**
- **ML75**
- **ML100**

# ML50

## / ROUND TUBE FINISHING MACHINE

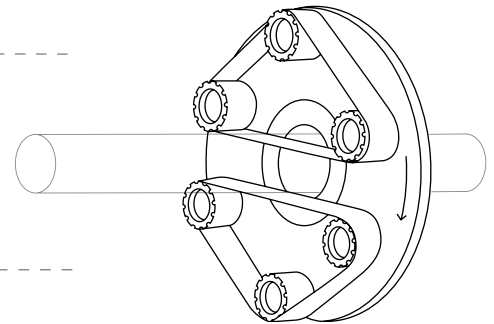

### TECHNICAL SPECIFICATIONS

diameter capacity (Ø mm)	5-50
feeding speed (m/min.)	manual
abrasive belt speed (m/s)	10-25
abrasive belt dimensions (mm)	25x500 (x2)
abrasive belt motor (kW)	2.2
wheel motor (kW)	1.5
consumption (A)	9
dimensions (mm)	605x735x1220
weight (kg)	155

### DEMONSTRATION VIDEO



### MINIMUM BEND CHART



### STANDARD EQUIPMENT

\_\_ Blocking system for wheel rotation

\_\_ Pedal for belts opening and wheel unblocking

\_\_ Variable speed for abrasive belts

### AVAILABLE ACCESSORIES

\_\_ Dust extractor



\_\_ slim and compact planetary wheel with 2 abrasive belts



\_\_ finishing curved tubes with tight radii

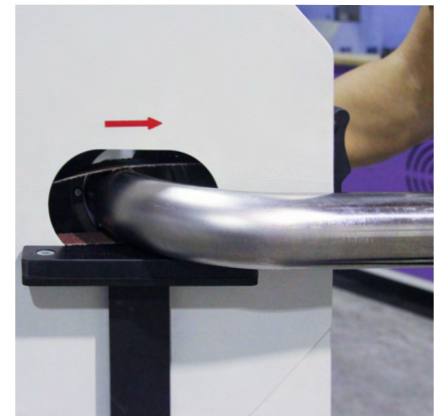

\_\_ flexibility in curved tube finishing

# ML75

## / ROUND TUBE FINISHING MACHINE

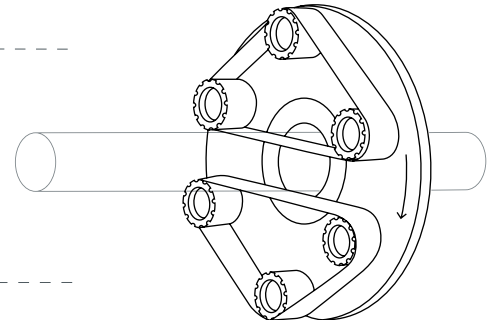

### DEMONSTRATION VIDEO



### MINIMUM BEND CHART



### STANDARD EQUIPMENT

Blocking system for wheel rotation

Pedal for belts opening and wheel unblocking

Variable speed for abrasive belts

### AVAILABLE ACCESSORIES

Automatic feeding system (4+4 rollers with variable speed)

Dust extractor

### TECHNICAL SPECIFICATIONS

diameter capacity (Ø mm)	10-76
feeding speed (m/min.)	manual or 1-5
abrasive belt speed (m/s)	10-25
abrasive belt dimensions (mm)	25x860 (x2)
abrasive belt motor (kW)	2.2
wheel motor (kW)	1.5
consumption (A)	12
dimensions (mm)	660x1000x1320
weight (kg)	230

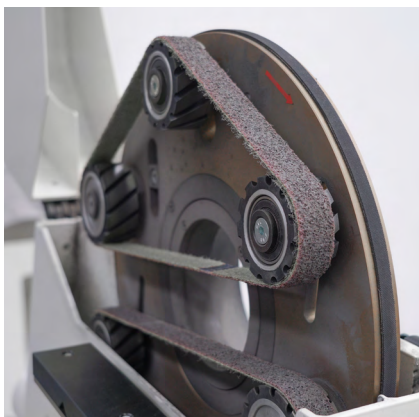

slim and compact planetary wheel with 2 abrasive belts



finishing curved tubes with tight radii

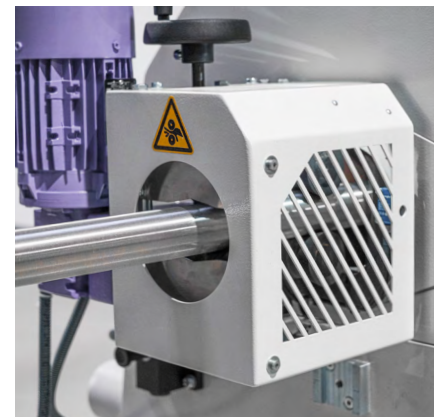

finishing straight tubes with automatic feeding

# ML100

/ ROUND TUBE FINISHING MACHINE

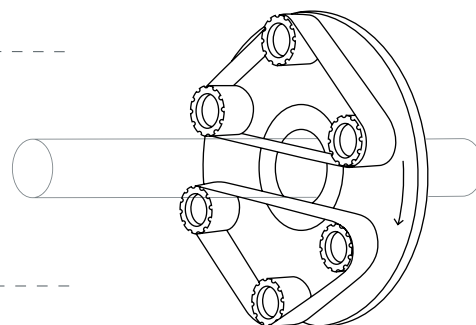

## DEMONSTRATION VIDEO



## MINIMUM BEND CHART



## STANDARD EQUIPMENT

Blocking system for wheel rotation

Pedal for belts opening and wheel unblocking

Variable speed for abrasive belts

## AVAILABLE ACCESSORIES

Automatic feeding system (4+4 rollers with variable speed)

Photocells for automatic belts opening and tube inversion

Touchscreen with programs

Dust extractor

## TECHNICAL SPECIFICATIONS

diameter capacity (Ø mm)	10-114
feeding speed (m/min.)	1-5
abrasive belt speed (m/s)	10-25
abrasive belt dimensions (mm)	50x940 (2x)
abrasive belt motor (kW)	3
wheel motor (kW)	1.5
consumption (A)	14
dimensions (mm)	720x1050x1340
weight (kg)	250



planetary wheel with 2 abrasive belts



automatic feeding for straight tubes



easily removable feeding units for bent tube finishing